

FNMP4

Cap
60° Cone

Mates with UT Style hose fittings

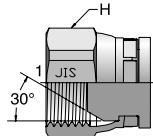

TUBE FITTING PART #	END SIZE		H HEX (in.)	STANDARD Dynamic Pressure (x 1,000 PSI)
	1 BSPP	2 BSPT		S
4FNMP4	1/4-19		0.75	5
6FNMP4	3/8-19		0.88	5
8FNMP4	1/2-14		1.06	5
12FNMP4	3/4-14		1.44	4
16FNMP4	1-11		1.63	3

C3P4 Full Dimensions

90° Male Elbow
60° Cone / BSPT

Mates with GU, G1 and G2 Style hose fittings

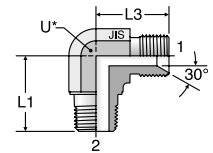

* Across wrench flats

TUBE FITTING PART #	END SIZE		L1 (in.)	L3 (in.)	U (in.)	STANDARD Dynamic Pressure (x 1,000 PSI)
	1 BSPP	2 BSPT				S
4C3P4	1/4 - 19	1/4 - 19	1.00	0.96	0.56	5
6C3P4	3/8 - 19	3/8 - 19	1.18	1.14	0.75	5
8C3P4	1/2 - 14	1/2 - 14	1.42	1.28	0.88	5
12C3P4	3/4 - 14	3/4 - 14	1.69	1.56	1.06	4
16C3P4	1-11	1-11	1.97	1.74	1.31	3

V3P4 Full Dimensions

45° Male Elbow
60° Cone / BSPT

Mates with GU, G1 and G2 Style hose fittings

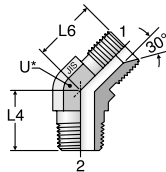

TUBE FITTING PART #	END SIZE		L4 (in.)	L6 (in.)	U (in.)	STANDARD Dynamic Pressure (x 1,000 PSI)
	1 BSPP	2 BSPT				S
4V3P4	1/4 - 19	1/4 - 19	0.75	0.81	0.56	5
6V3P4	3/8 - 19	3/8 - 19	0.87	0.91	0.75	5
8V3P4	1/2 - 14	1/2 - 14	1.06	1.05	0.88	5
12V3P4	3/4 - 14	3/4 - 14	1.18	1.18	1.06	4
16V3P4	1-11	1-11	1.37	1.3	1.31	3

P47OMN

Plug

Hex head plug for JIS B2351

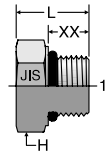

TUBE FITTING PART #	END SIZE		H HEX (mm)	L (mm)	XX (mm)	STANDARD Dynamic Pressure (x 1,000 PSI)
	1 BSPP	2 BSPT				S
4P47OMN	1/4-19		19	19.1	11.2	5
6P47OMN	3/8-19		22	20.0	11.2	5
8P47OMN	1/2-14		27	24.1	14.5	5
12P47OMN	3/4-14		36	26.9	14.5	4
16P47OMN	1-11		41	31.0	18.5	3

Dimensions and pressures for reference only, subject to change.

Visual Index

How To Order

Specs

Assembly / Installation

Reference Section